

AERODROME CHART - ICAO

ARP  
N47 37 38  
E017 48 30  
AERODROME ELEV 426

PÉR INFO 129.900  
BUDAPEST INFO (WEST) 125.500

GYÖR/PÉR

| RWY   | DIRECTION | THR                   | BEARING STRENGTH | TORA | TODA | ASDA | LDA  |
|---|-----------|-----------------------|------------------|------|------|------|------|
| 12  | 116°      | N47 37 58, E017 47 36 | PCN 50/F/C/W/T   | 2030 | 2030 | 2130 | 2030 |
| 30  | 296°      | N47 37 26, E017 49 00 | PCN 50/F/C/W/T   | 2030 | 2030 | 2130 | 2030 |
| Apron 1   |           |                       | PCN 45/R/C/W/T   |      |      |      |      |
| Apron 2   |           |                       | -                |      |      |      |      |
| Apron 3   |           |                       | PCN 61/R/C/W/T   |      |      |      |      |
| Taxiway: A  |           |                       | PCN 50/F/C/W/T   |      |      |      |      |
| Taxiway: A1, A2                                   |           |                       | PCN 44/F/C/W/U   |      |      |      |      |
| Taxiways: B                                       |           |                       | -                |      |      |      |      |
| Taxiway width: A: 15 m; A1, B: 7.5 m; A2: 10.5 m. |           |                       |                  |      |      |      |      |

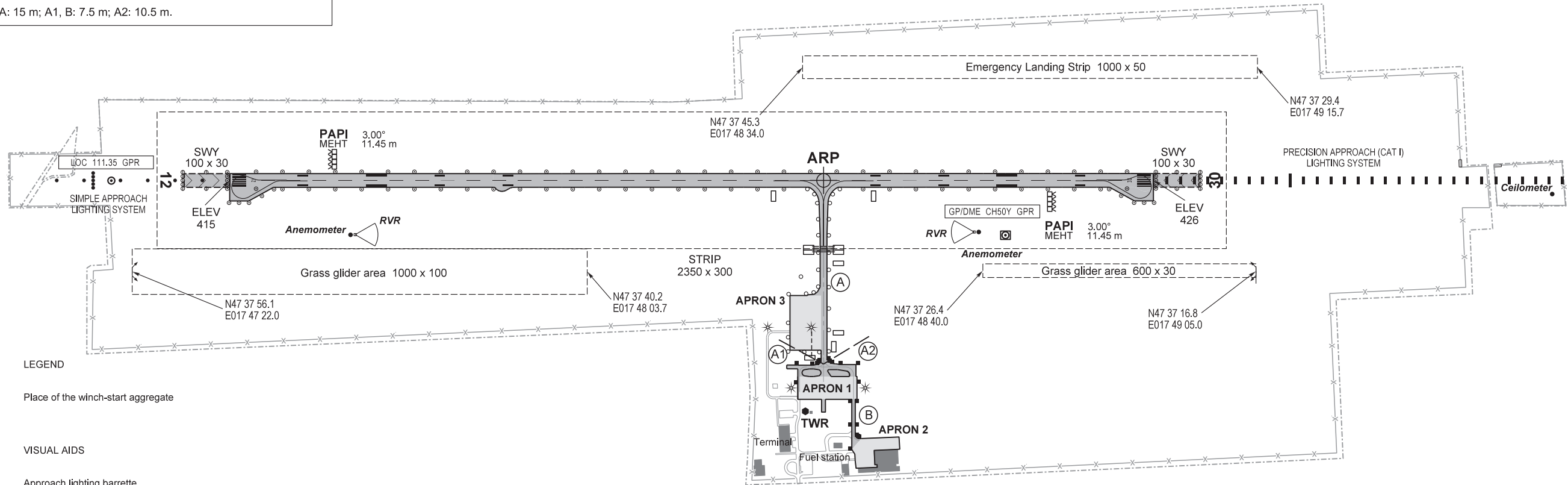

LEGEND

Place of the winch-start aggregate

VISUAL AIDS

- Approach lighting barrette
- Approach light
- PAPI
- RWY lights (edge, -threshold, -end)
- Stopway lights
- TWY edge marker
- Retroreflective TWY edge marker
- Flood lighting
- Non illuminated taxiing guidance sign

FOR BASIC CHART SYMBOLS SEE GEN 3.2.

AERODROME GUND: NOT AVAILABLE.  
THR GUND: NOT AVAILABLE.  
APRON ELEVATION: NOT AVAILABLE.  
GEOGRAPHICAL COORDINATES FOR TWY CENTERLINES: NOT AVAILABLE.  
OBSTACLE TO TAXIING: NOT AVAILABLE.

LIGHTING

RWY 12/30

**Approach:** Cat. I, high intensity (900 m) on THR 30, SALS medium intensity (420 m) on THR 12.  
**Threshold:** Green.  
**PAPI:** 3.00° (11.45 m).  
**Stopway:** Red (100 m).  
**Runway edge:** High intensity white/yellow (2030 m), spacing: 58 m.  
**Runway end:** Red.

ELEVATIONS ARE IN FEET  
AND DIMENSIONS IN METRES  
BEARINGS ARE MAGNETIC

HORIZONTAL SCALE 1 : 10 000

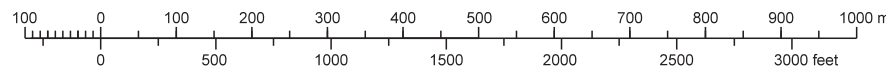

| INS COORDINATES FOR AIRCRAFT STANDS |               |
|-------------------------------------|---------------|
| 1-7                                 | NOT AVAILABLE |

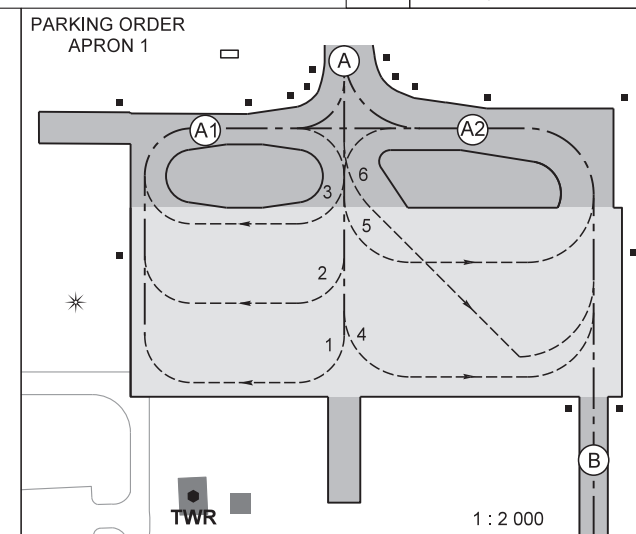
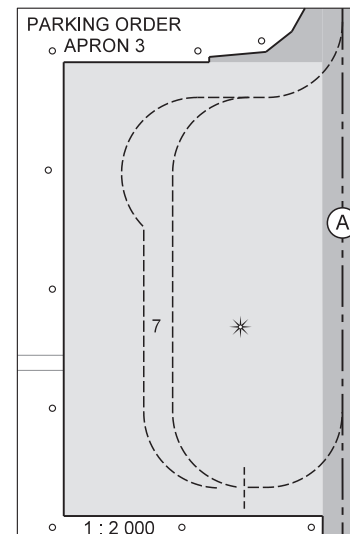

THE PAGE INTENTIONALLY LEFT BLANK